

M10.5

Screw Threaded (M10.5 * 1.0) Metal Nut

Panel Cut-Out

Assemble Style

Hexagonal Flange

Circular Flange

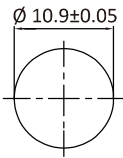
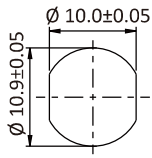

(Unit: mm)



Solder
(S) Receptacle

Number of Contacts		2	3	4	5
Rated Voltage (AC/DC)		60V			
Nominal current		2A			
Plastic / Metal		Metal			
Pin Assignment		MF	MF	MF	MF
MF : Male Connector Female Contact					
M10.5 X 1.0 Bulkhead / Receptacle, Circular Flange, REAR Fastened Nut, IP67					
Nut Torque Value: 5 ~ 8 kgf-cm Recommended Panel Thickness: Max 6.0mm					
	Metal Nut, Solder Pins	105-02PMFS-SC7001	105-03PMFS-SC7001	105-04PMFS-SC7001	105-05PMFS-SC7001
	Stainless, Solder Pins	S105-02PMFS-SC7001*	S105-03PMFS-SC7001*	S105-04PMFS-SC7001*	S105-05PMFS-SC7001*
M10.5 Bulkhead / Receptacle With UL1061 PVC Wires, Circular Flange, REAR Fastened Nut, IP67					
⑩ Wire Length: (10) 100mm ~ (95) 950mm (per 50mm) (A0) 1,000mm ~ (A5) 1,500mm (Per 100mm) Standard Lengths: (25) 250mm and (50) 500mm					
	Metal Nut	105-02PMFS-SC7A⑩*	105-03PMFS-SC7A⑩*	105-04PMFS-SC7A⑩*	105-05PMFS-SC7A⑩*
	Stainless	S105-02PMFS-SC7A⑩*	S105-03PMFS-SC7A⑩*	S105-04PMFS-SC7A⑩*	S105-05PMFS-SC7A⑩*
M10.5 x 1.0 Bulkhead / Receptacle, Hexagonal Flange, REAR Fastened Nut, IP67					
	Metal Nut, Solder Pins	105-02PMFS-SH7001	105-03PMFS-SH7001	105-04PMFS-SH7001	105-05PMFS-SH7001
	Stainless, Solder Pins	S105-02PMFS-SH7001*	S105-03PMFS-SH7001*	S105-04PMFS-SH7001*	S105-05PMFS-SH7001*
M10.5 Bulkhead / Receptacle With UL1061 PVC Wires, Hexagonal Flange, REAR Fastened Nut, IP67					
⑩ Wire Length: (10) 100mm ~ (95) 950mm (per 50mm) (A0) 1,000mm ~ (A5) 1,500mm (Per 100mm) Standard Lengths: (25) 250mm and (50) 500mm					
	Metal Nut	105-02PMFS-SH7A⑩*	105-03PMFS-SH7A⑩*	105-04PMFS-SH7A⑩*	105-05PMFS-SH7A⑩*
	Stainless	S105-02PMFS-SH7A⑩*	S105-03PMFS-SH7A⑩*	S105-04PMFS-SH7A⑩*	S105-05PMFS-SH7A⑩*

* Upon Request

M10.5

Screw Threaded (M10.5 * 1.0) Metal Nut

Number of Contacts	2	3
Rated Voltage (AC/DC)	60V	
Nominal current	2A	
Plastic / Metal	Metal	
Pin Assignment	FM	FM
FM: Female Connector Male Contact		

STRAIGHT, Overmolded Cable Assembly, Free Cable End, IP67

10 Cable Length: (01) 1M ~ (99) 99M | Standard Lengths: 1M, 2M, 3M, 4M, 5M and 10M

	Metal Nut	UL2464, PVC	105-02BFMM-SL7A 10*	105-03BFMM-SL7A 10*
		UL20549, PUR	105-02BFMM-SL7B 10*	105-03BFMM-SL7B 10*
		UL2517, PVC	105-02BFMM-SL7D 10*	105-03BFMM-SL7D 10*
	Shielded	UL2464, PVC	105S-02BFMM-SL7A 10*	105S-03BFMM-SL7A 10*
		UL20549, PUR	105S-02BFMM-SL7B 10*	105S-03BFMM-SL7B 10*
		UL2517, PVC	105S-02BFMM-SL7D 10*	105S-03BFMM-SL7D 10*
	Stainless	UL2464, PVC	S105-02BFMM-SL7A 10*	S105-03BFMM-SL7A 10*
		UL20549, PUR	S105-02BFMM-SL7B 10*	S105-03BFMM-SL7B 10*
		UL2517, PVC	S105-02BFMM-SL7D 10*	S105-03BFMM-SL7D 10*
	Stainless Shielded	UL2464, PVC	S105S-02BFMM-SL7A 10*	S105S-03BFMM-SL7A 10*
		UL20549, PUR	S105S-02BFMM-SL7B 10*	S105S-03BFMM-SL7B 10*
		UL2517, PVC	S105S-02BFMM-SL7D 10*	S105S-03BFMM-SL7D 10*

RIGHT ANGLE, Overmolded Cable Assembly, Free Cable End, IP67

10 Cable Length: (01) 1M ~ (99) 99M | Standard Lengths: 1M, 2M, 3M, 4M, 5M and 10M

	Metal Nut	UL2464, PVC	105-02BFMM-SR7A 10*	105-03BFMM-SR7A 10*
		UL20549, PUR	105-02BFMM-SR7B 10*	105-03BFMM-SR7B 10*
		UL2517, PVC	105-02BFMM-SR7D 10*	105-03BFMM-SR7D 10*
	Shielded	UL2464, PVC	105S-02BFMM-SR7A 10*	105S-03BFMM-SR7A 10*
		UL20549, PUR	105S-02BFMM-SR7B 10*	105S-03BFMM-SR7B 10*
		UL2517, PVC	105S-02BFMM-SR7D 10*	105S-03BFMM-SR7D 10*
	Stainless	UL2464, PVC	S105-02BFMM-SR7A 10*	S105-03BFMM-SR7A 10*
		UL20549, PUR	S105-02BFMM-SR7B 10*	S105-03BFMM-SR7B 10*
		UL2517, PVC	S105-02BFMM-SR7D 10*	S105-03BFMM-SR7D 10*
	Stainless Shielded	UL2464, PVC	S105S-02BFMM-SR7A 10*	S105S-03BFMM-SR7A 10*
		UL20549, PUR	S105S-02BFMM-SR7B 10*	S105S-03BFMM-SR7B 10*
		UL2517, PVC	S105S-02BFMM-SR7D 10*	S105S-03BFMM-SR7D 10*

Pin Assignment

FF: Female Connector Female Contact

STRAIGHT-TO-STRAIGHT, Overmolded Double-Ended Cable Assembly, IP67

10 Cable Length: (001) 1M ~ (099) 99M | Standard Lengths: 1M, 2M, 3M, 4M, 5M and 10M

	Metal Nut	UL2464, PVC	10502BL-105BL-SL7A 10*	10503BL-105BL-SL7A 10*
		UL20549, PUR	10502BL-105BL-SL7B 10*	10503BL-105BL-SL7B 10*
		UL2517, PVC	10502BL-105BL-SL7D 10*	10503BL-105BL-SL7D 10*
	Shielded	UL2464, PVC	105S02BL-105SB L-SL7A 10*	105S03BL-105SB L-SL7A 10*
		UL20549, PUR	105S02BL-105SB L-SL7B 10*	105S03BL-105SB L-SL7B 10*
		UL2517, PVC	105S02BL-105SB L-SL7D 10*	105S03BL-105SB L-SL7D 10*
	Stainless	UL2464, PVC	S10502BL-S105B L-SL7A 10*	S10503BL-S105B L-SL7A 10*
		UL20549, PUR	S10502BL-S105B L-SL7B 10*	S10503BL-S105B L-SL7B 10*
		UL2517, PVC	S10502BL-S105B L-SL7D 10*	S10503BL-S105B L-SL7D 10*
	Stainless Shielded	UL2464, PVC	S105S02BL-S105S B L-SL7A 10*	S105S03BL-S105S B L-SL7A 10*
		UL20549, PUR	S105S02BL-S105S B L-SL7B 10*	S105S03BL-S105S B L-SL7B 10*
		UL2517, PVC	S105S02BL-S105S B L-SL7D 10*	S105S03BL-S105S B L-SL7D 10*

STRAIGHT-TO-RIGHT ANGLE, Overmolded Double-Ended Cable Assembly, IP67

10 Cable Length: (001) 1M ~ (099) 99M | Standard Lengths: 1M, 2M, 3M, 4M, 5M and 10M

	Metal Nut	UL2464, PVC	10502BL-105BR-SL7A 10*	10503BL-105BR-SL7A 10*
		UL20549, PUR	10502BL-105BR-SL7B 10*	10503BL-105BR-SL7B 10*
		UL2517, PVC	10502BL-105BR-SL7D 10*	10503BL-105BR-SL7D 10*
	Shielded	UL2464, PVC	105S02BL-105SB R-SL7A 10*	105S03BL-105SB R-SL7A 10*
		UL20549, PUR	105S02BL-105SB R-SL7B 10*	105S03BL-105SB R-SL7B 10*
		UL2517, PVC	105S02BL-105SB R-SL7D 10*	105S03BL-105SB R-SL7D 10*
	Stainless	UL2464, PVC	S10502BL-S105B R-SL7A 10*	S10503BL-S105B R-SL7A 10*
		UL20549, PUR	S10502BL-S105B R-SL7B 10*	S10503BL-S105B R-SL7B 10*
		UL2517, PVC	S10502BL-S105B R-SL7D 10*	S10503BL-S105B R-SL7D 10*
	Stainless Shielded	UL2464, PVC	S105S02BL-S105S B R-SL7A 10*	S105S03BL-S105S B R-SL7A 10*
		UL20549, PUR	S105S02BL-S105S B R-SL7B 10*	S105S03BL-S105S B R-SL7B 10*
		UL2517, PVC	S105S02BL-S105S B R-SL7D 10*	S105S03BL-S105S B R-SL7D 10*

RIGHT ANGLE-TO-RIGHT ANGLE, Overmolded Double-Ended Cable Assembly, IP67



10 Cable Length: (001) 1M ~ (099) 99M | Standard Lengths: 1M, 2M, 3M, 4M, 5M and 10M

	Metal Nut	UL2464, PVC	10502BR-105BR-SL7A 10*	10503BR-105BR-SL7A 10*
		UL20549, PUR	10502BR-105BR-SL7B 10*	10503BR-105BR-SL7B 10*
		UL2517, PVC	10502BR-105BR-SL7D 10*	10503BR-105BR-SL7D 10*
	Shielded	UL2464, PVC	105S02BR-105SB R-SL7A 10*	105S03BR-105SB R-SL7A 10*
		UL20549, PUR	105S02BR-105SB R-SL7B 10*	105S03BR-105SB R-SL7B 10*
		UL2517, PVC	105S02BR-105SB R-SL7D 10*	105S03BR-105SB R-SL7D 10*
	Stainless	UL2464, PVC	S10502BR-S105B R-SL7A 10*	S10503BR-S105B R-SL7A 10*
		UL20549, PUR	S10502BR-S105B R-SL7B 10*	S10503BR-S105B R-SL7B 10*
		UL2517, PVC	S10502BR-S105B R-SL7D 10*	S10503BR-S105B R-SL7D 10*
	Stainless Shielded	UL2464, PVC	S105S02BR-S105S B R-SL7A 10*	S105S03BR-S105S B R-SL7A 10*
		UL20549, PUR	S105S02BR-S105S B R-SL7B 10*	S105S03BR-S105S B R-SL7B 10*
		UL2517, PVC	S105S02BR-S105S B R-SL7D 10*	S105S03BR-S105S B R-SL7D 10*

* Upon Request

M10.5

Screw Threaded (M10.5 * 1.0) Metal Nut

Number of Contacts	4	5
Rated Voltage (AC/DC)	60V	
Nominal current	2A	
Plastic / Metal	Metal	
Pin Assignment	FM	FM
FM: Female Connector Male Contact		

STRAIGHT, Overmolded Cable Assembly, Free Cable End, IP67

10 Cable Length: (01) 1M ~ (99) 99M | Standard Lengths: 1M, 2M, 3M, 4M, 5M and 10M

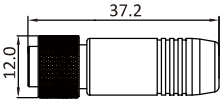
	Metal Nut	UL2464, PVC	105-04BFMM-SL7A 10	105-05BFMM-SL7A 10
		UL20549, PUR	105-04BFMM-SL7B 10*	105-05BFMM-SL7B 10*
		UL2517, PVC	105-04BFMM-SL7D 10*	105-05BFMM-SL7D 10*
	Shielded	UL2464, PVC	105S-04BFMM-SL7A 10*	105S-05BFMM-SL7A 10*
		UL20549, PUR	105S-04BFMM-SL7B 10*	105S-05BFMM-SL7B 10*
		UL2517, PVC	105S-04BFMM-SL7D 10*	105S-05BFMM-SL7D 10*
	Stainless	UL2464, PVC	S105-04BFMM-SL7A 10*	S105-05BFMM-SL7A 10*
		UL20549, PUR	S105-04BFMM-SL7B 10*	S105-05BFMM-SL7B 10*
		UL2517, PVC	S105-04BFMM-SL7D 10*	S105-05BFMM-SL7D 10*
	Stainless Shielded	UL2464, PVC	S105S-04BFMM-SL7A 10*	S105S-05BFMM-SL7A 10*
		UL20549, PUR	S105S-04BFMM-SL7B 10*	S105S-05BFMM-SL7B 10*
		UL2517, PVC	S105S-04BFMM-SL7D 10*	S105S-05BFMM-SL7D 10*

RIGHT ANGLE, Overmolded Cable Assembly, Free Cable End, IP67

10 Cable Length: (01) 1M ~ (99) 99M | Standard Lengths: 1M, 2M, 3M, 4M, 5M and 10M

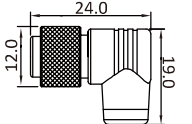
	Metal Nut	UL2464, PVC	105-04BFMM-SR7A 10	105-05BFMM-SR7A 10
		UL20549, PUR	105-04BFMM-SR7B 10*	105-05BFMM-SR7B 10*
		UL2517, PVC	105-04BFMM-SR7D 10*	105-05BFMM-SR7D 10*
	Shielded	UL2464, PVC	105S-04BFMM-SR7A 10*	105S-05BFMM-SR7A 10*
		UL20549, PUR	105S-04BFMM-SR7B 10*	105S-05BFMM-SR7B 10*
		UL2517, PVC	105S-04BFMM-SR7D 10*	105S-05BFMM-SR7D 10*
	Stainless	UL2464, PVC	S105-04BFMM-SR7A 10*	S105-05BFMM-SR7A 10*
		UL20549, PUR	S105-04BFMM-SR7B 10*	S105-05BFMM-SR7B 10*
		UL2517, PVC	S105-04BFMM-SR7D 10*	S105-05BFMM-SR7D 10*
	Stainless Shielded	UL2464, PVC	S105S-04BFMM-SR7A 10*	S105S-05BFMM-SR7A 10*
		UL20549, PUR	S105S-04BFMM-SR7B 10*	S105S-05BFMM-SR7B 10*
		UL2517, PVC	S105S-04BFMM-SR7D 10*	S105S-05BFMM-SR7D 10*

Pin Assignment

FF: Female Connector Female Contact

STRAIGHT-TO-STRAIGHT, Overmolded Double-Ended Cable Assembly, IP67

10 Cable Length: (001) 1M ~ (099) 99M | Standard Lengths: 1M, 2M, 3M, 4M, 5M and 10M

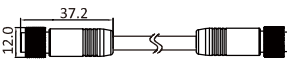
	Metal Nut	UL2464, PVC	10504BL-105BL-SL7A 10*	10505BL-105BL-SL7A 10*
		UL20549, PUR	10504BL-105BL-SL7B 10*	10505BL-105BL-SL7B 10*
		UL2517, PVC	10504BL-105BL-SL7D 10*	10505BL-105BL-SL7D 10*
	Shielded	UL2464, PVC	105S04BL-105SBL-SL7A 10*	105S05BL-105SBL-SL7A 10*
		UL20549, PUR	105S04BL-105SBL-SL7B 10*	105S05BL-105SBL-SL7B 10*
		UL2517, PVC	105S04BL-105SBL-SL7D 10*	105S05BL-105SBL-SL7D 10*
	Stainless	UL2464, PVC	S10504BL-S105BL-SL7A 10*	S10505BL-S105BL-SL7A 10*
		UL20549, PUR	S10504BL-S105BL-SL7B 10*	S10505BL-S105BL-SL7B 10*
		UL2517, PVC	S10504BL-S105BL-SL7D 10*	S10505BL-S105BL-SL7D 10*
	Stainless Shielded	UL2464, PVC	S105S04BL-S105SBL-SL7A 10*	S105S05BL-S105SBL-SL7A 10*
		UL20549, PUR	S105S04BL-S105SBL-SL7B 10*	S105S05BL-S105SBL-SL7B 10*
		UL2517, PVC	S105S04BL-S105SBL-SL7D 10*	S105S05BL-S105SBL-SL7D 10*

STRAIGHT-TO-RIGHT ANGLE, Overmolded Double-Ended Cable Assembly, IP67

10 Cable Length: (001) 1M ~ (099) 99M | Standard Lengths: 1M, 2M, 3M, 4M, 5M and 10M

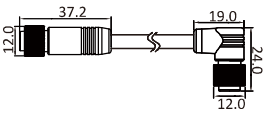
	Metal Nut	UL2464, PVC	10504BL-105BR-SL7A 10*	10505BL-105BR-SL7A 10*
		UL20549, PUR	10504BL-105BR-SL7B 10*	10505BL-105BR-SL7B 10*
		UL2517, PVC	10504BL-105BR-SL7D 10*	10505BL-105BR-SL7D 10*
	Shielded	UL2464, PVC	105S04BL-105SBR-SL7A 10*	105S05BL-105SBR-SL7A 10*
		UL20549, PUR	105S04BL-105SBR-SL7B 10*	105S05BL-105SBR-SL7B 10*
		UL2517, PVC	105S04BL-105SBR-SL7D 10*	105S05BL-105SBR-SL7D 10*
	Stainless	UL2464, PVC	S10504BL-S105BR-SL7A 10*	S10505BL-S105BR-SL7A 10*
		UL20549, PUR	S10504BL-S105BR-SL7B 10*	S10505BL-S105BR-SL7B 10*
		UL2517, PVC	S10504BL-S105BR-SL7D 10*	S10505BL-S105BR-SL7D 10*
	Stainless Shielded	UL2464, PVC	S105S04BL-S105SBR-SL7A 10*	S105S05BL-S105SBR-SL7A 10*
		UL20549, PUR	S105S04BL-S105SBR-SL7B 10*	S105S05BL-S105SBR-SL7B 10*
		UL2517, PVC	S105S04BL-S105SBR-SL7D 10*	S105S05BL-S105SBR-SL7D 10*

RIGHT ANGLE-TO-RIGHT ANGLE, Overmolded Double-Ended Cable Assembly, IP67

10 Cable Length: (001) 1M ~ (099) 99M | Standard Lengths: 1M, 2M, 3M, 4M, 5M and 10M

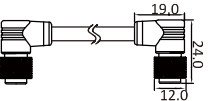
	Metal Nut	UL2464, PVC	10504BR-105BR-SL7A 10*	10505BR-105BR-SL7A 10*
		UL20549, PUR	10504BR-105BR-SL7B 10*	10505BR-105BR-SL7B 10*
		UL2517, PVC	10504BR-105BR-SL7D 10*	10505BR-105BR-SL7D 10*
	Shielded	UL2464, PVC	105S04BR-105SBR-SL7A 10*	105S05BR-105SBR-SL7A 10*
		UL20549, PUR	105S04BR-105SBR-SL7B 10*	105S05BR-105SBR-SL7B 10*
		UL2517, PVC	105S04BR-105SBR-SL7D 10*	105S05BR-105SBR-SL7D 10*
	Stainless	UL2464, PVC	S10504BR-S105BR-SL7A 10*	S10505BR-S105BR-SL7A 10*
		UL20549, PUR	S10504BR-S105BR-SL7B 10*	S10505BR-S105BR-SL7B 10*
		UL2517, PVC	S10504BR-S105BR-SL7D 10*	S10505BR-S105BR-SL7D 10*
	Stainless Shielded	UL2464, PVC	S105S04BR-S105SBR-SL7A 10*	S105S05BR-S105SBR-SL7A 10*
		UL20549, PUR	S105S04BR-S105SBR-SL7B 10*	S105S05BR-S105SBR-SL7B 10*
		UL2517, PVC	S105S04BR-S105SBR-SL7D 10*	S105S05BR-S105SBR-SL7D 10*

* Upon Request

Waterproof Cap

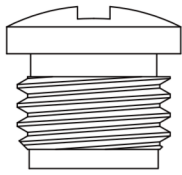

M8 (For Female)

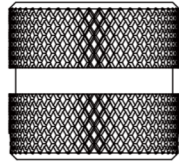

M10.5 (For Male)

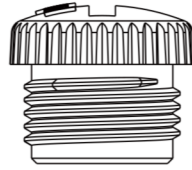

M12 (For Female)

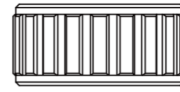

M23 (For Male)

Size	Mating Pair	Mating Gender	Material	Attachment	Screw Thread
M8	Overmolded with Cable	Female	Plastic	With Lead	CAP-WBBFSPC1
		Female	Plastic	Cap Only	CAP-WBBFSMA1
	Receptacle and Overmolded with Cable	Male	Plastic	Cap Only	CAP-WBBMSMA1
		Female	Plastic	Cap Only	CAP-WBBFSMA1
M10.5	Receptacle and Overmolded with Cable	Male	Metal	Cap Only	CAP-WBCMSMA2
M12 A / B / D / I K / L / S / T / X	Receptacle	Male	Metal	With Chain	CAP-WBDMSPB2
		Female	Metal	With Chain	CAP-WBDFSPB1
	Receptacle and Overmolded with Cable	Male	Plastic	Cap Only	CAP-WBDMSMA1
		Male	Metal	Cap Only	CAP-WBDMSMA2
		Female	Plastic	Cap Only	CAP-WBDFSMA1
		Female	Metal	Cap Only	CAP-WBDFSMA2
M23	Receptacle	Male	Metal	Cap Only	CAP-WBHMSMA1

Customization - Upon Request

1. M8 / M12 Sensor Insert

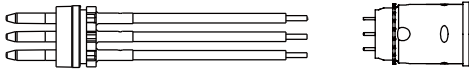

8. M8 To X-Lok



2. Square Receptacle

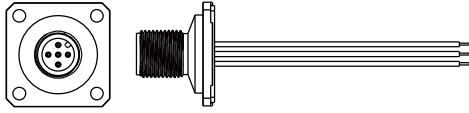

9. M12 Receptacle Feedthrough

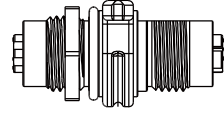

3. Metal Injection Molding

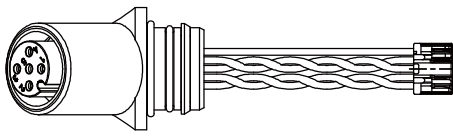

10. With FPC Termination

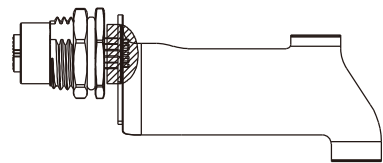

4. M12 To USB Plug

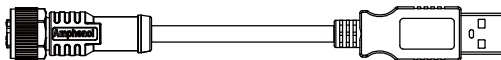

5. M12 To USB Jack Splitter

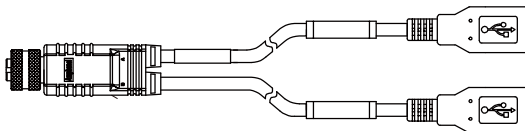

6. M12 To D-Sub

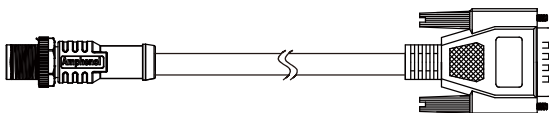

7. M12 To FLOS (FLOS+)

