

**Description**

**CSPT22A12-4.0F:**

Chinasound SMD Piezo Transducer 22mm diameter, type A(=7mm height) , 12Vp-p rated voltage – 4.0KHz resonant frequency, lead Free reflowing solderable and RoHS compliant

◆ **RoHS compliant**

- ◆ Reliable Solid State Piezoelectric Technology
- ◆ Corrosion Resistance Diaphragm
- ◆ Flame Retardant Plastic
- ◆ Tape and reel packaging for auto mounting

**Picture**



**Frequency Response Curve**

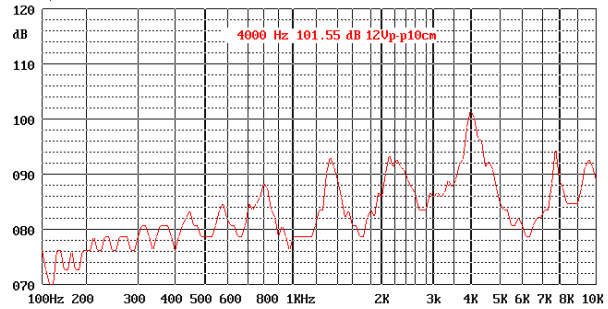

**Specification**

Rated Voltage	12 Vp-p
Operating Voltage	1 ~ 25 Vp-p
Operating Frequency	4000+/-500Hz
Typical Sound Output	90dB min. (100dB typ.) at 12Vp-p 10cm 4.0KHz 25 °C
Rated Current	3mA at 12Vp-p
Capacitance	15000+/-30% pF at 100Hz 1Vrms
Operating Temperature	-30 °C to +85 °C
Storage Temperature	-40 °C to +90 °C
Termination	Description 2 soldering pads, Sn plated Brass
Construction Materials	Case Plastic, PPS A7-03A Diaphragm Ni Alloy Disc N42
Weight (Typical)	2.8g
Reliability	*Life Test At 12 Vp-p in room temperature for 1000 hours *High Temperature No function at +90+/-2 °C for 240 hours; Function at +85+/-2 °C for 240 hours *Low Temperature No function at -40+/-2 °C for 240 hours; Function at -30+/-2 °C for 240 hours *Humidity +40+/-2 °C, 95+/-5%RH, 240 hours *Thermal Shock -30+/-2 °C 0.5 hr → +25+/-2 °C 0.25 hr → +85+/-2 °C 0.5 hr → +25+/-2 °C 0.25 hr. Temperature Go up or Drop time is 0.5 hr. 3 hrs per 1 cycle. Total is 5 cycles *Vibration 1.5mm with 10 to 50Hz of vibration frequency to each of 3 perpendicular directions for 2 hours *Shock 980m/s <sup>2</sup> (=100g) shock for each mutually perpendicular directions, half sine wave, 3 times each *Drop Test Dropped naturally from 750mm height onto the surface of 10mm wooden board. 2 directions – upper and side of the part are applied *Soldering Heat Resistance Samples put through reflowing soldering over 2 twice **Solderability Samples put on PCB with solder paste through reflowing soldering over 1 times

**Warranty**

\*All specifications must be satisfied after the test (Recovery:2 to 4 hrs of recovery under the standard condition after the removal from test chamber).  
\*\*90% min. soldering pads shall be with solder.(except the edge of pad)

**Dimensions (Unit:mm)**

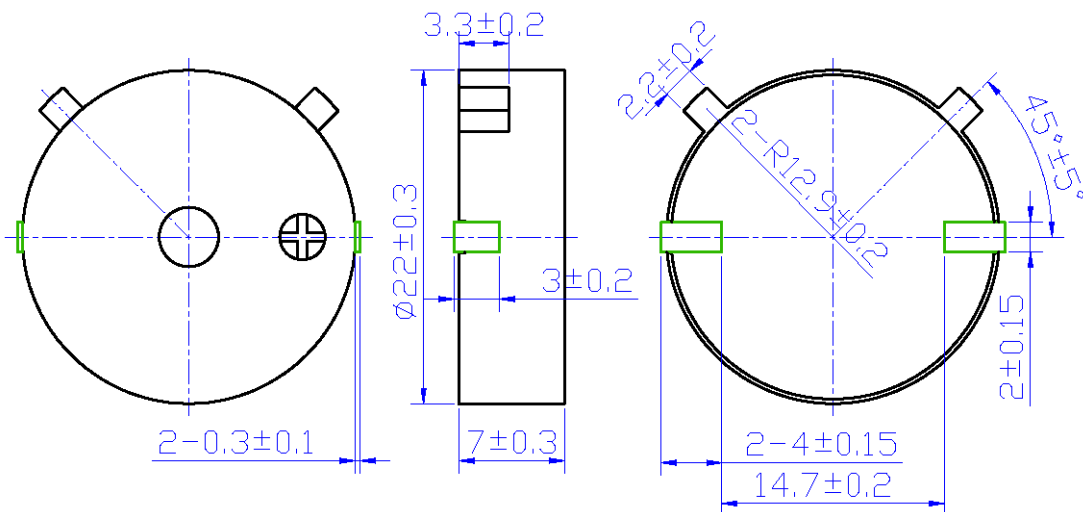

All specifications are subject to change without notice

Tape & Reel Dimensions (Unit:mm)

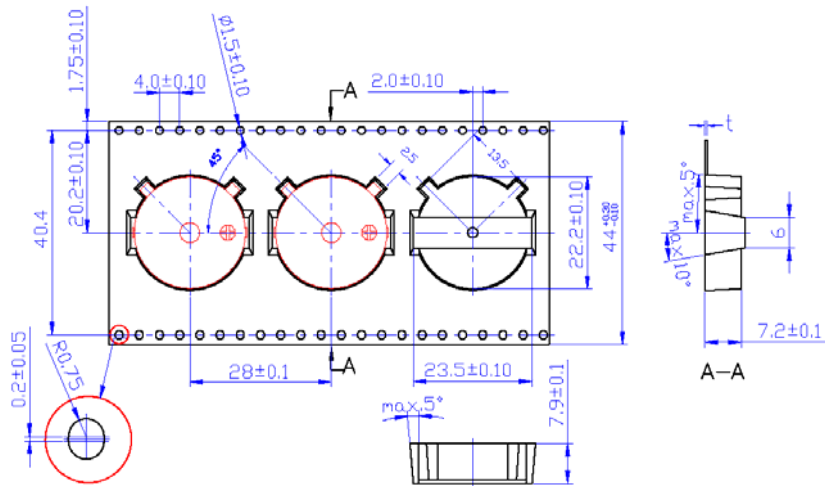

NOTE:

1. 10 sprocket hole pitch cumulative tolerance +/-0.20mm.
2. Carrier camber not to exceed 1 mm in 100 mm.
3. All dimensions meet EIA-481-2-A requirements.
4. Thickness: 0.40+/-0.05 mm.
5. Component loaded per 13" reel: 300 pcs.

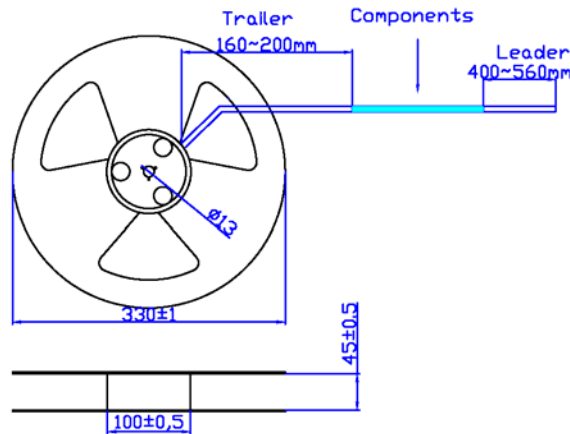

Recommend Reflowing Profile

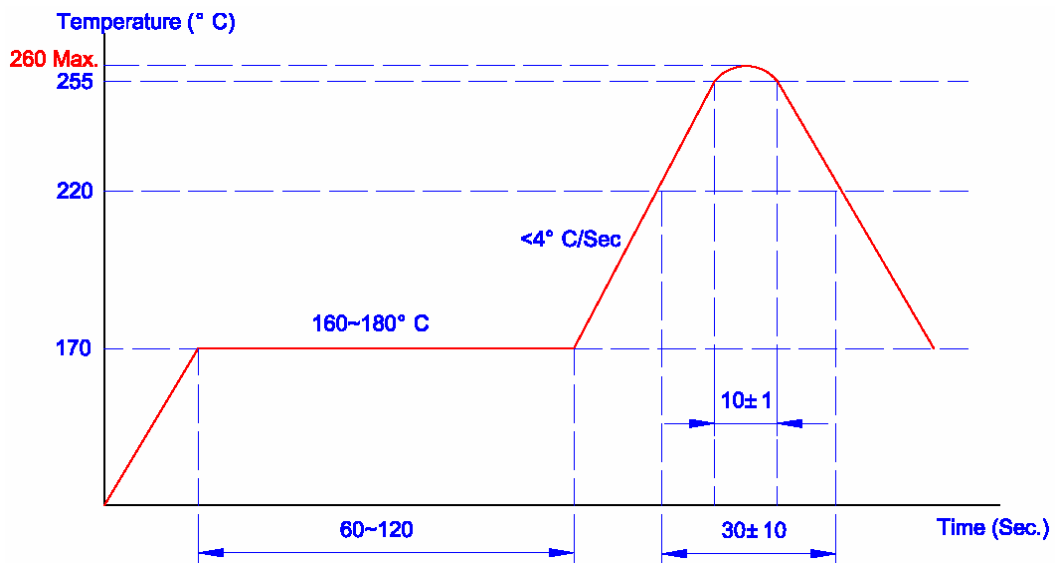

All specifications are subject to change without notice