

APPROVED: \_\_\_\_\_  
 DATE: \_\_\_\_\_ TITLE: \_\_\_\_\_

Rev	AWO #	Description	Date	Appr
-		RELEASED	12/7/15	
A		UPDATED SPEC.	6/16/16	HR/MW
B		UPDATED SPEC.	7/18/16	HR/MW
C		UPDATED DRAWING	2/18/19	HR/RC
D		UPDATED DRAWING	4/13/20	OW/KL

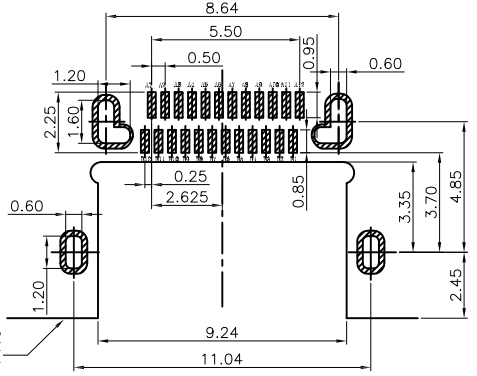
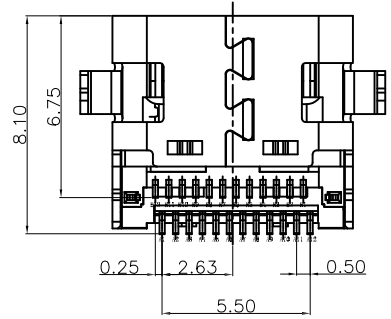
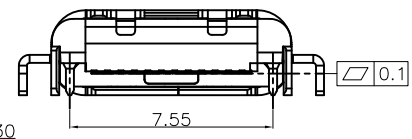
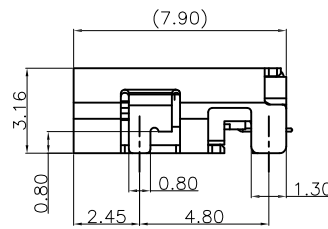
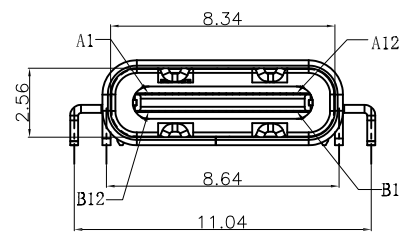
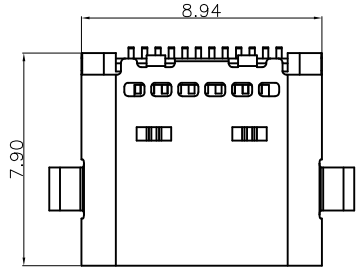

RECOMMENDED PCB LAYOUT

**SPECIFICATIONS:**  
 Material:  
 Insulator: Hi-temp thermoplastic, rated UL 94V-0  
 Insulator color: Black  
 Contacts: Copper Alloy  
 Shell: Stainless Steel, Nickel plated  
 Spring: Stainless Steel  
 Plating:  
 Gold flash over Nickel underplate overall  
 Electrical:  
 Current rating: 3 A max.  
 Contact resistance: 40 mohms max.  
 Dielectric withstanding voltage: 100 VDC for 1 minute  
 Mechanical:  
 Insertion force: 5~20 N  
 Unmating force: 8~20 N (Initial)  
 Durability: 10,000 cycles  
 Environmental:  
 Lead free, RoHS compliant.



PACKAGED ON TAPE & REEL

UNLESS OTHERWISE SPECIFIED ALL DIMENSIONS ARE MILLIMETERS TOLERANCES: EXCEPT AS NOTED		
MM	ANGLE	
X. ± 0.50	X.* ± 3°	
.X ± 0.30	.X* ± 2°	
.XX ± 0.20	.XX* ± 1°	
.XXX ± 0.10	.XXX* ± 0.5°	
APPROVALS		DATE
DRAWN	HR	12/7/15
CHECKED	TW	12/7/15
APPROVED		

**ADAM TECH INTERCONNECTS** 909 Rahway Avenue,  
 Union, NJ 07083  
 Phone: 908-687-5000  
 Fax: 908-687-5710

TITLE: UNIVERSAL SERIAL BUS, TYPE C, FEMALE, SMT TYPE, EDGE HANG, BLACK INSULATOR		
SIZE X	PART NO. USB-C31-S-RA-EH2-SMT-BK-T/R	REV. D
REF: S00097C	SCALE: NTS	SHEET 1 OF 1