

CONFIDENTIAL

VERTRAULICH

THIS DRAWING IS THE EXCLUSIVE PROPERTY OF MARQUARDT. WITHOUT THEIR CONSENT IT MAY NOT BE REPRODUCED OR GIVEN TO THIRD PARTIES.

Alle Rechte bei Marquardt, auch fuer den Fall von Schutzrechtsanmeldungen. Jede Veruegungsbefugnis, wie Kopier- und Weitergaberecht, bei uns.

A	recommended cut-out for snap-in fixing (edge opposite to snap-in direction)	1	2	3	4
			wall thickness	length of cut-out	width of cut-out
		0.75 to 1.25	19.2 -0.1	21.9+0.1	
		1.25 to 2	19.4 -0.1	21.9+0.1	
		2 to 3	19.8 -0.1	21.9+0.1	

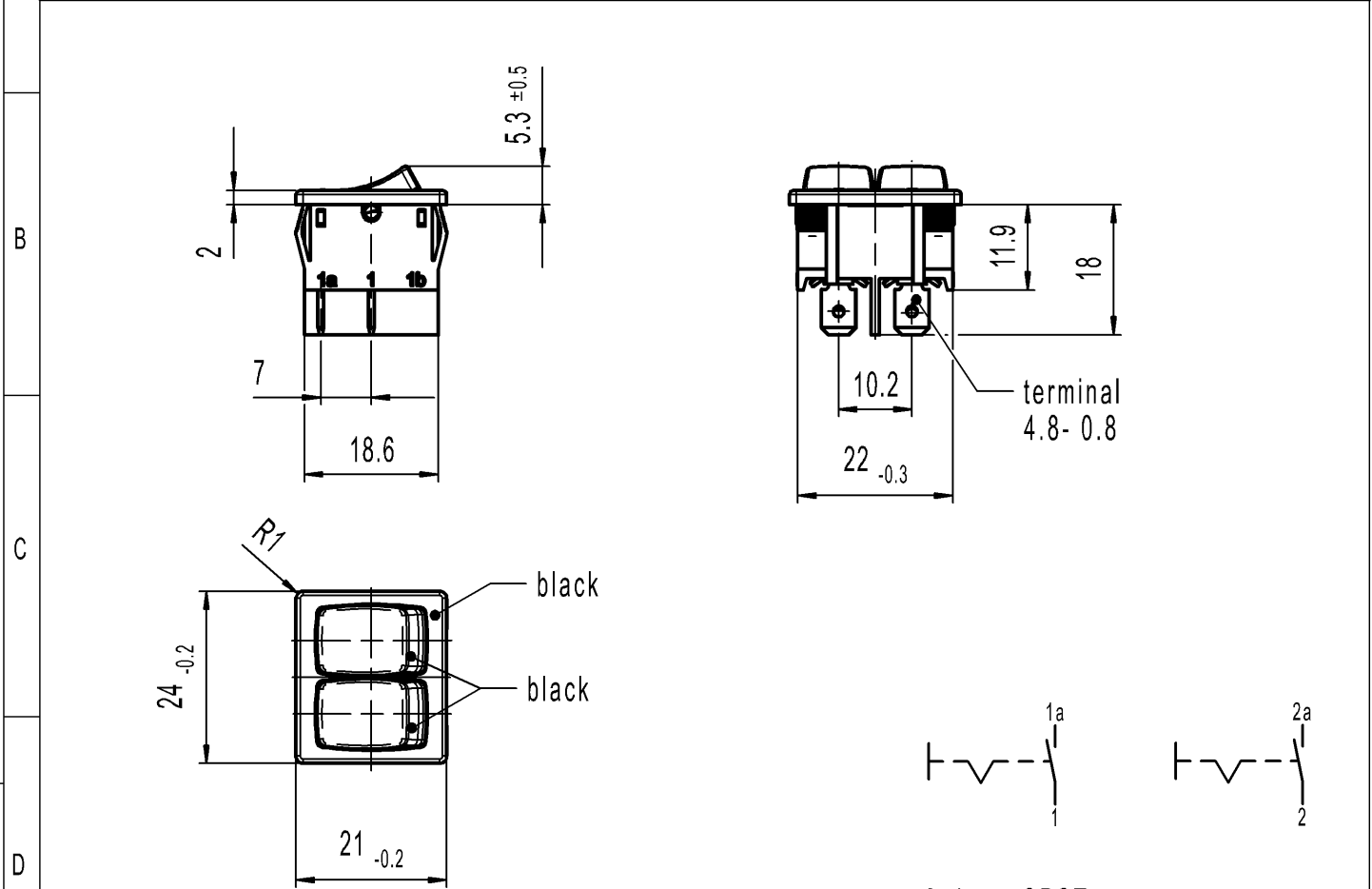

2 times SPST
Suitable for appliances of class II

Marking

1806.
 6(4)/250~5E4 T100/55
 10(4)/250~

6A 125-250V AC
 1/4 HP 125V AC
 1/2 HP 250V AC
 R30

Code of manufacture: place/year/week

-	-	-	1806.1102-XX
Figure	Type	Customer Part No.	Art.No.-PI
Shape and location	Angle ± 2 °	Sheet 01	Ident. K
	Edge tolerance	Format DIN A4	Document number 18061102
	Length	Projection	Index f
	Radii	Scale 1:1	Appliance Switch
f	137893	All dimensions are in millimetres	
e	64492	System NX V1872	
d	29285	Replacement of	
c	26171	Zg.gl.Nr.v.24.10.1996	
Index	MEC-No.	Date (YYYY-MM-DD)	Edited by

