

6LR61 Standard 9V

Product specifications for cylindrical
alkaline battery

6LR61 Standard 9V

1. Battery Identification

Name	9V/ 6LR61/ 6AM6/ MN1604
Type	alkaline/ metal jacket
Nominal Voltage	9 V
Electrolyte	KOH (potassium hydroxide)
Average Weight	46 g
Nominal internal resistance	+/- 2.1 Ohm (1kHz – fresh)

2. Battery Dimensions

Dimension	Max	min	Typical
A	48.5	46.5	48.0
B	46.4		44.2
C	26.5	24.5	25.6
D	17.5	15.0	16.5
E	13.0	12.45	12.7

Unit : mm

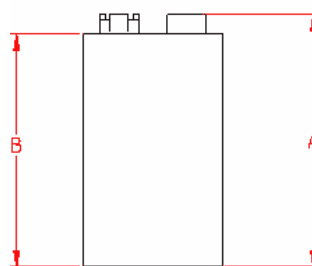
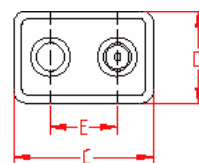

3. Battery Performance

A. Typical Discharge Values

TEST	RESISTANCE	DAILY PERIOD	END POINT	TYPICAL	MIN AVG
Radio	620 ohm	2 h	5.4 V	43,5h	38,6h
Toy/Motor	270 ohm	1h	5.4 V	19h	17,1h
Smoke detector	620 ohm+10kOhm	1sec/h-24h/d	7.5 V	18 days	tbc

6LR61 Standard 9V

4. Discharge Curves

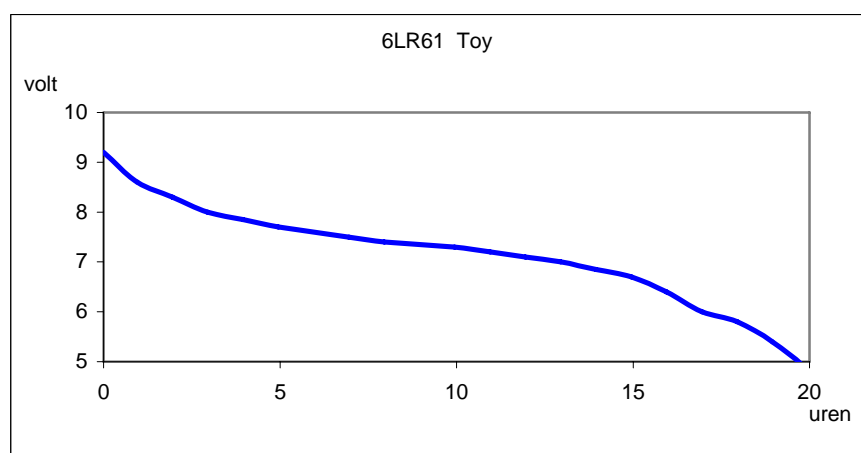
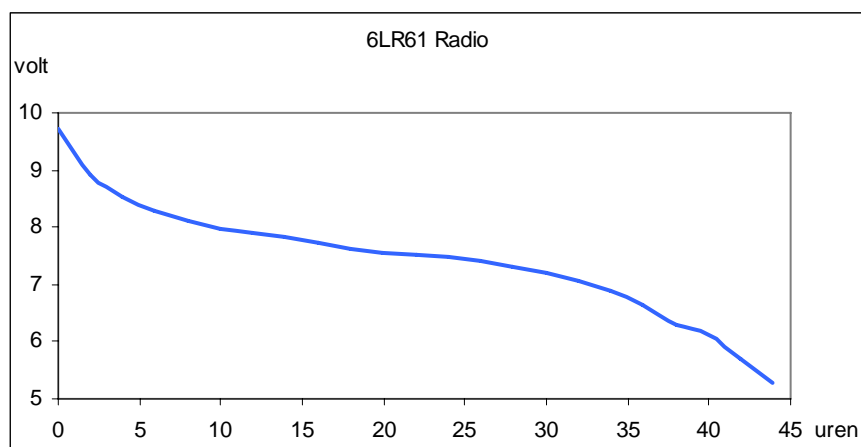

6LR61 Standard 9V

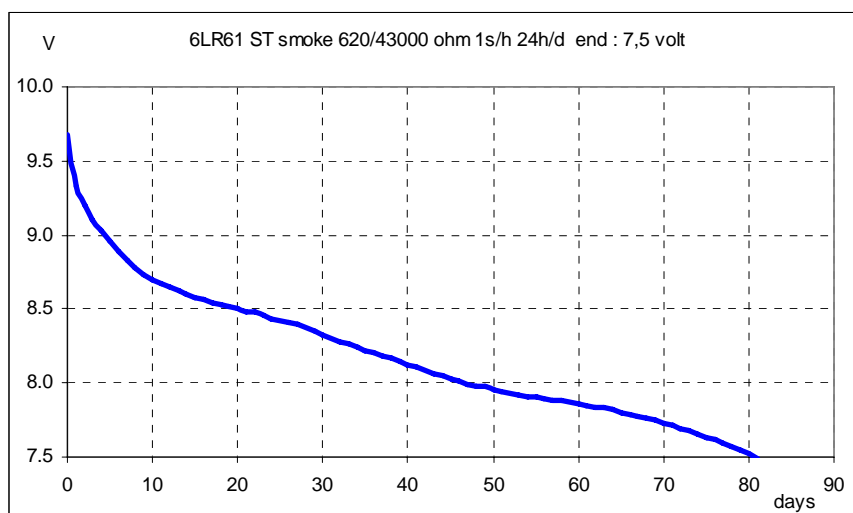

5. Material Safety Data Sheet

Item	Material	%
Total Weight		42,11 g
Cathode	MnO ₂ /C	34%
Anode	Zn/KOH	16%
Separator/Connection paper	Paper	1,0%
Current Collector	Brass	4%
Electrolyte	KOH/H ₂ O	6%
Steel Can/Lead/Terminals	Ni plated steel	17,0%
Bottomplate/Metal Jacket	Sn plated steel	16,0%
Label/Terminal base/Insulation sleeve	PVC	5%
Spacer	Cardbord	1,0%

No Mercury (Hg), Cadmium (Cd) or Lead (Pb) are used in the battery.