

LR14 Standard

Product specifications for cylindrical
alkaline battery

LR14 Standard

1. Battery Identification

Name	L/ LR14/ AM2/ C/ MN1400
Type	alkaline/ foil
Nominal Voltage	1.5 V
Electrolyte	KOH (potassium hydroxide)
Average Weight	63.3 g
Nominal internal resistance	+/- 90 mOhm (1kHz – fresh)

2. Battery Dimensions

Dimension	Max	Min	Typical
A	50.0		49.6
B		48.6	49.3
C		13.0	17.4
E	0.9		0.3
F	7.5		6.3
G		1.5	2.2
Ø	26.2	24.9	25.4

Unit : mm

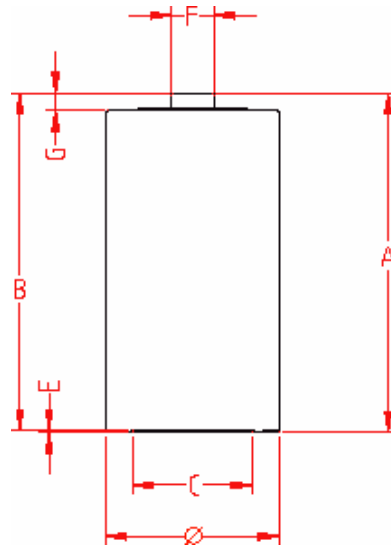

3. Battery Performance

A. Typical Discharge Values

TEST	RESISTANCE	DAILY PERIOD	END POINT	TYPICAL	MIN AVG
Radio	20 ohm	4h	0,9V	115h	105h
Motor	3,9 Ohm	1h	0,8V	20,5h	17,8h
LIF	3,9 Ohm	4min/h-8h	0,9V	1215min	1088min
Stereo	400 mA	2h	0,9V	11,7h	9,2h

LR14 Standard

4. Discharge Curves

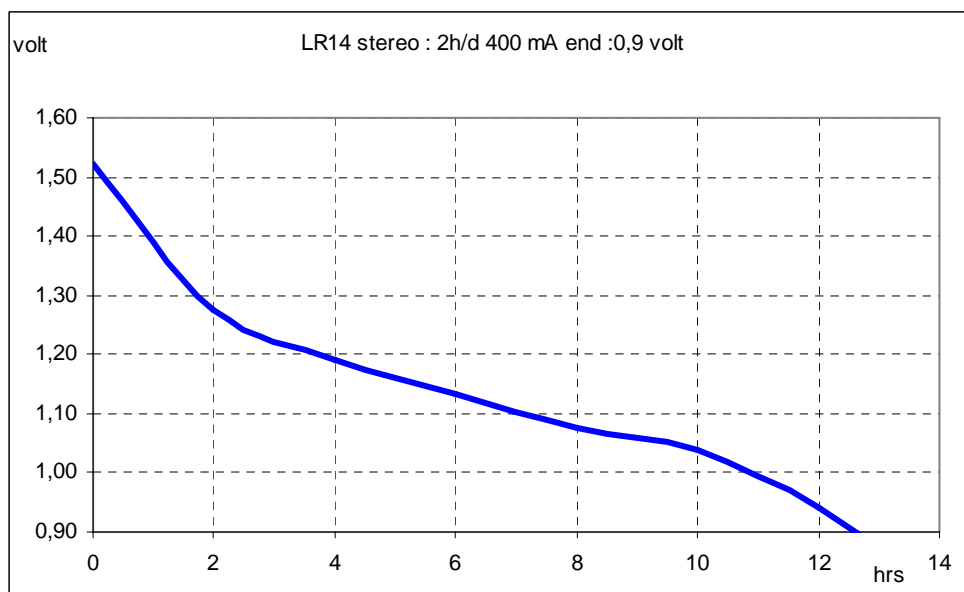
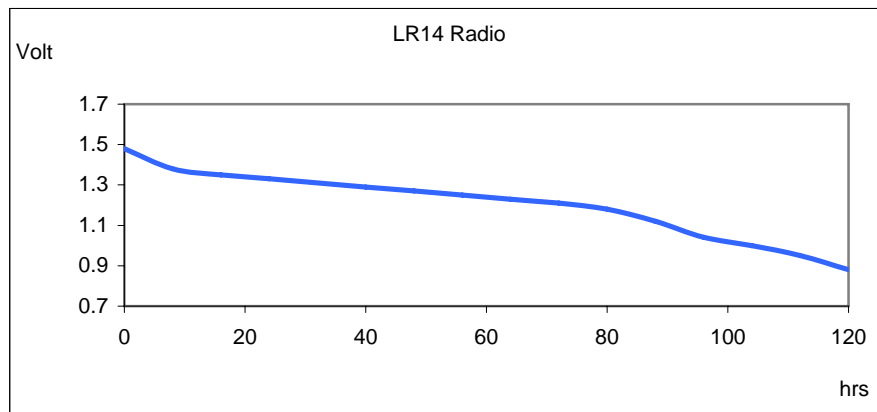

LR14 Standard

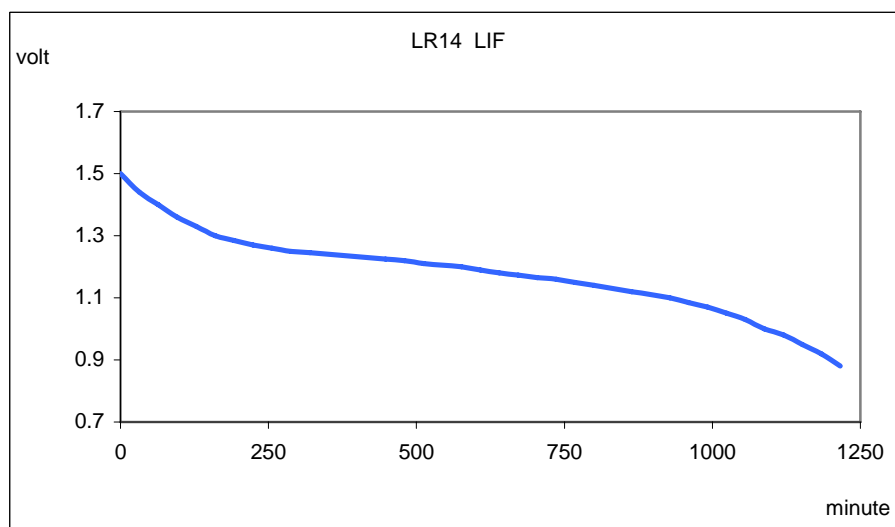
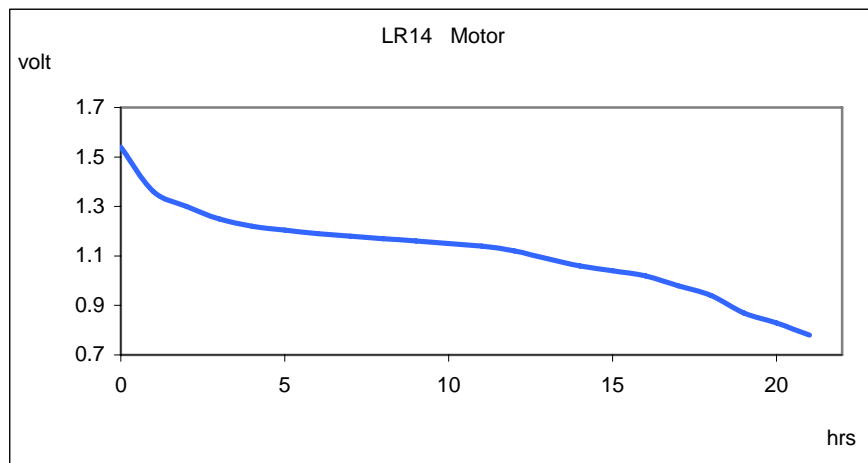

5. Material Safety Data Sheet

Item	Material	%
Total Weight		66,3 g
Cathode	MnO ₂ /C	46%
Anode	Zn/KOH	25%
Separator	Paper	1%
Current Collector	Brass	2%
Electrolyte	KOH/H ₂ O	6%
Steel Can	Ni plated steel	15%
Bottomplate	Ni plated steel	3%
Label	PVC	2%

No Mercury (Hg), Cadmium (Cd) or Lead (Pb) are used in the battery.